



PAR-P4DUALDRIR28NH-AI

(2) 4 Megapixel Dual Channel, Non-Splicing IP Plug & Play, Outdoor Dome, Up to 98' IR Range, WDR, 2-Built-in Mics with Audio Input/Output, SD Card Slot, 12VDC/PoE

Features

- True AI Human & Vehicle Classification for Line Crossing, Intrusion Detection, & Other AI Features
- True P2P Connectivity with QR Code Connect NAT 2.0
- (2) 4 Megapixel Resolution Cameras Non-Splicing
- Dual Fixed 2.8mm Lens
- True Day/Night with IR Range up to 98'
- H.265+, H.265, H.264+, H.264 Compression
- 30 FPS Recording
- True WDR 120dB
- Micro SD Slot: Up to 512GB
- 2-Built-in Mics: Audio Input
- Audio Output
- IP66 Weather Resistant
- IK10 Vandal Resistant
- 12VDC/PoE Operation
- ONVIF
- Free iOS & Android Apps for Smart Phones & Tablets
- Free Central Management Software (CMS) for PC/MAC

Resolution	4MP (2688×1520), 2K (2560×1440), 3MP(2304×1296), 1080P (1920×1080), 720P (1280×720), D1, VGA(640×480), 640×360, CIF, 480 × 240										
Main Stream	4MP/2K/3MP/1080P (60Hz : 1 ~ 30fps; 50Hz: 1~25fps)										
Sub Stream	720P/D1/VGA/640×360/480×240/CIF(60Hz : 1 ~ 30fps; 50Hz: 1~25fps)										
Third Stream	D1/CIF/480×240 (60Hz : 1 ~ 30fps; 50Hz: 1~25fps)										
Bit Rate	64 Kbps ~ 8 Mbps										
Bit Rate Type	VBR / CBR										
Audio Compression	G711A / U										
Image Settings	ROI, Saturation, Brightness, Hue, Contrast, Wide Dynamic, Sharpness, Image Mirror, Image Flip, NR, etc. adjustable through client software or web browser										
ROI	Each ROI to be configured separately										
Intelligent Analytics											
Smart Event	Line crossing, region intrusion/entrance/exiting (human/vehicle classification) loitering detection, illegal parking detection, abandoned/ missing object detection										
Statistics	Target counting by line/area, heat map										
Exception Detection	Scene change, video blur and abnormal color detection, audio exception										
Face Detection	Face detection and face capture										
DORI Distance											
DORI Distance	<table border="1"> <thead> <tr> <th>Lens</th> <th>Detect</th> <th>Observe</th> <th>Recognize</th> <th>Identify</th> </tr> </thead> <tbody> <tr> <td>2.8mm</td> <td>19ft (58m)</td> <td>76ft (23m)</td> <td>38ft (12m)</td> <td>19ft (6m)</td> </tr> </tbody> </table>	Lens	Detect	Observe	Recognize	Identify	2.8mm	19ft (58m)	76ft (23m)	38ft (12m)	19ft (6m)
Lens	Detect	Observe	Recognize	Identify							
2.8mm	19ft (58m)	76ft (23m)	38ft (12m)	19ft (6m)							
Interfaces											
Network	RJ 45 10M/100M self-adaptive Ethernet port										
Video Output	Yes										
Audio	1CH audio input; 1CH audio output; 2CH built-in MICs; 1CH built-in speaker										
Storage	Built-in micro SD card slot; up to 512GB										
Reset	Yes										
Alarm	2CH alarm input; 2CH alarm output										
Power Output	Yes, max. DC12V@100mA										
Functions											
Remote Monitoring	Web Browser/Paramont CMS/NVR/mobile APP										
Web Browser	Chrome 89.0+/Edge 89.0+/Firefox 87.0+/Safari 14.0+										
Online Connection	Support simultaneous monitoring for up to 10 users; Support multi-stream real time transmission										
Network Protocol	UDP, IPv4, IPv6, DHCP, NTP, RTSP, RTP, RTMP, RTCP, PPPoE, DDNS, SMTP, FTP, SNMP, HTTP, HTTP POST, 802.1x, UPnP, HTTPS, P2P, QoS										
Interface Protocol	ONVIF (Profile G/S/T/M)										
Storage	Network remote storage; micro SD card storage										
Smart Alarm	Motion detection, SMD, SD card error, SD card full, IP address conflict, network disconnection, audio alarm										
General Function	Watermark, video mask, heartbeat, image distortion correction, corridor pattern, disarming, ANR, cloud upgrade										
Security	Video encryption, firmware encryption, HTTPS encryption, configuration encryption, illegal login lock, IP address filtering, 802.1x authentication, basic and digest authentication for HTTP/RTSP/API services										
PoE	Yes , IEEE802.3af										
IR Distance	98'										
Ingress Protection	IP 66 & IK10										
Others											
Power Supply	DC12V/PoE										
Power Consumption	<9.5W										
Storage Conditions	-22°F ~ 149°F (- 30 °C ~ 65°C), Humidity: less than 95 % (non-condensing)										
Operating Conditions	-22°F ~ 140°F (- 30 °C ~ 60 °C), Humidity: less than 95 % (non-condensing)										
Dimensions	6.5 x 3.8 x 2.8 in (165.4 x 97.4 x 72mm)										
Weight (net)	Approx. 1.66lbs (0.755KG)										
Installation	Ceiling mounting; Wall mounting										
Certificate	CE, FCC										
Environmental Protection	Directive EU RoHS, WEEE(2012/19/EU) , directive 94/62/EC and REACH(EC1907/2006)										

Camera	PAR-P4DUALDRIR28NH-AI
Image Sensor	1 / 3 "CMOS*2
Image Size	2688 × 1520
Electronic Shutter	1 / 3 s ~ 1 / 100000 s
Iris Type	Fixed Iris
Min. Illumination	0.005 lux@F1.6,AGC ON;0 lux with IR
Lens	2.8 mm@F1.6, Horizontal FoV: 101°; vertical FoV: 55°; diagonal FoV:122°
Focus	Fixed
Lens Mount	M12
Day & Night	ICR
Wide Dynamic Range	120dB
BLC	Yes
HLC	Yes
Defog	Yes
S/N Ratio	≥50dB
Digital NR	3D DNR
Angle Adjustment	Pan: -90°~90°; Tilt:0°~65°; Rotation: 0°~355°
Image	
Video Compression	Main/Third stream: H.265+ / H.265 / H.264+ / H.264 Sub stream: H.265+ / H.265 / H.264+ / H.264 / MJPEG
H.264 Compression Standard	Baseline Profile/Main Profile/High Profile

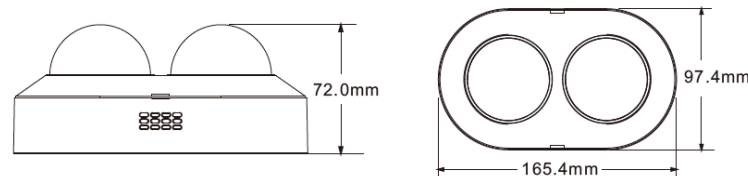

Ordering Information

PAR-P4DUALDRIR28NH-AI: 4 Megapixel Dome Dual 2.8mm Lens

InVid Tech, reserves the right to make changes to improve our products at any time without notice; we are not responsible for misprints.