

IP Camera

KNC-HMS6330-iB

- 1/2.8" 2.13MP Sony STARVIS CMOS
- 1080p(1920x1080)@30(25)fps
- H.264 Main/Baseline Profiles
- Fixed lens 3.6mm or Pinhole lens
4.3mm • Electronic Day&Night
- 3D DNR, DSS, BLC, WDR
- 12VDC / PoE
- 2 seconds boot-up complete

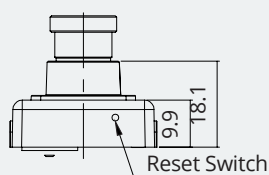
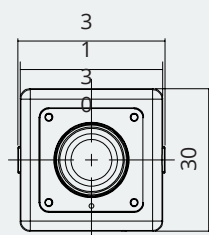

IP Camera KNC-HMS6330-iB

Dimensions

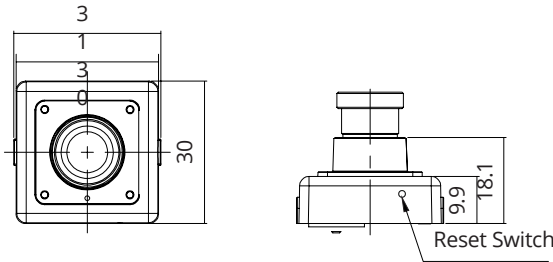

Specifications

Image Sensor	1/2.8" Progressive Scan SONY STARVIS CMOS		Ethernet	10/100 Base-T Ethernet	
Effective Pixels	1945(H) x 1097(V)		Video Compression Format	H.264 Baseline, Main Profile, MJPEG	
Scanning	Progressive scan		Video Resolution	1920x1080, 1280x720, 800x600, 704x480, 704x400, 640x480, 640x360, 320x240	
Min.Illumination	0.05Lux(F2.5, DSS Off) / 0.01Lux(DSS On)		Max. Frame Rate	First: 1080p 30(25)fps (H.264) Second : 640x360 30(25)fps (H.264) Third : 1080p 30(25)fps (MJPEG)	
S/N ratio	≤50dB		Streaming Capability	Multiple Streaming(Up to 3 Profiles)	
Video Output	Network	Network	Streaming Method	Unicast	
	Analog	-	Bitrate Control	H.264 : CBR, VBR, CVBR	
	Type	Fixed lens	Max.User Access	5	
Lens	Focal Length	3.6mm, F 2.0	IP	IPv4	
	Angle of View	-	Protocol	HTTP, HTTPS, UPnP, DNS, DDNS, RTP/RTSP, TCP/IP, UDP, DHCP, RARP, NTP	
	2.8mm	131 (D)x113 (H)x63 (V)	Security	-	
Board Lens	3.6mm	112.3 (D)x93.7 (H)x49.3 (V)	Web Viewer	Web browser	Internet Explorer, Edge, Safari, Firefox, Chrome
	6.0mm	62.1 (D)x53.9 (H)x30.1 (V)		Language	English
	8.0mm	44.8 (D)x39.3 (H)x22.4 (V)	External Storage	-	
	4.3mm	84.3 (D)x71.5 (H)x38.4 (V)	SW Integration API	Onvif	
White Balance	Auto, 3000K, 5000K, 8000K		Ingress Protection Grade	-	
Dynamic Range	Method	Double Shutter WDR	Color/Material	Black / Zn	
	Level(dB)	116dB (Estimated)	Dimension(mm)	30mmX30mm	
Electronic Shutter Speed	1/25(30)~1/30,000		Weight	Approx.79.6g (with PoE Cable)	
Auto Gain Control(AGC)	Off~69dB		Operating Temperature	-10°C~+50°C	
Day&Night	AUTO/COLOR/B&W (Electronic D&N)		Storage Temperature	-20°C~+60°C	
Digital Slow Shutter(DSS)	OFF~x32		Supply Voltage	12VDC(±10%) , PoE(IEEE802.3af)	
Noise Reduction	2D, 3D DNR		Power Consumption	12VDC(Max.190mA), PoE (Max.3.0W)	
Motion Detection	60x34 Motion Block, upto 4 Zones				
Privacy Masking Zone	16 Zones				
	Alarm In/Out	-			
Alarm	Alarm Triggers	Motion			
	Alarm Events	Network			