

WAT-3200 1/2.8" High Sensitivity 3G/HD-SDI B&W camera

Added high sensitivity B&W version to the 3G/HD-SDI camera series

NEW



Key features

- 1/2.8-inch BSI CMOS image sensor with high sensitivity
- Full HD 1080/60p resolution with 3G-SDI/HD-SDI interface and low latency
- Min. illumination 0.0001x F1.4 (AGC HIGH=72dB Shutter=OFF)
0.00007x F1.4 (AGC HIGH=72dB, Shutter=x15)

Dimensions

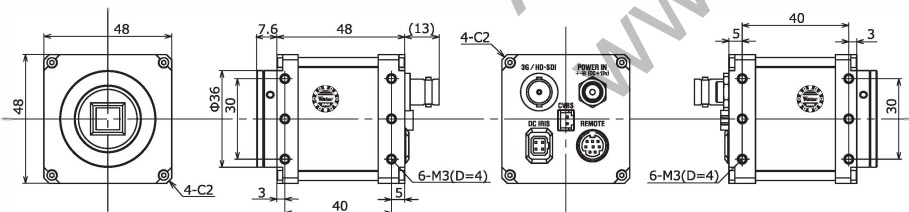

Specifications

Pick-up Element	1/2.8 inch BSI CMOS image sensor	
Number of Effective Pixels	1945(H) × 1097(V)	
Unit Cell Size	2.9µm(H) × 2.9µm(V)	
Imaging System	-	
Synchronizing System	Internal	
Scanning System	Progressive	
Video Outputs	3G-SDI, HD-SDI, HD-VLC Composite video: 1.0 V(p-p) 75Ω (Unbalanced)	
Output Format	1080/60p, 1080/59.94p, 1080/50p, 1080/60i, 1080/59.94i, 1080/50i, 1080/30p, 1080/29.97p, 1080/25p, 1080/24p, 720/60p, 720/59.94p, 720/50p, NTSC, PAL	
Resolution(H)	More than 1000TVL (Center)	
Min. Illumination	0.0001 lx F1.4 (AGC HIGH=72dB, Shutter=OFF) 0.00007 F1.4 (AGC HIGH=72dB, Shutter=x15)	
S/N	More than 50dB (AGC OFF=0dB, γ=1.0)	
Function Setting	OSD : Remote controller, RS-232 (Pelco-D, Pelco-P), Communication: RS-232 (Pelco-D, Pelco-P, Visca)	
AE Mode	Fixed	x2, x3, x4, x5, x6, x7, x8, x9, x10, x12, x15 (frame) 1/30, 1/60, 1/120, 1/180, 1/240, 1/300 sec.*1 1/25, 1/50, 1/100, 1/150, 1/200, 1/250 sec.*2
	EI	1/500, 1/1000, 1/2000, 1/5000, 1/10000 sec. 1/30 - 1/10000 sec.*1 1/25 - 1/10000 sec.*2
White Balance	-	
AGC	ON	0 - 72dB (MAX: 0 - 72dB)
	OFF	0dB
MGC	0 - 72dB (5dB Step)	
Day/Night	-	
Gamma Characteristics	γ=USER (Level adjustable)	
Noise Reduction	3DNR OFF/ON Level adjustable, 2DNR OFF/ON Level adjustable, 3D+2DNR ON Level adjustable	
Wide Dynamic Range	WDR OFF/ON Level adjustable, D-WDR OFF/ON Level adjustable	
Lens Iris	DC	
Back Light Compensation	BLC, HSBLC	
White Blemish Correction	Up to 2046 pixels	
Sharpness	OFF/ON Level adjustable	
Defog	OFF/ON Level adjustable	
Digital Zoom	ZOOM (x1.01 - x6.00), PAN/TILT	
Privacy Mask	8 masks	
Mirror Image	OFF, V-FLIP, H-FLIP, HV-FLIP	
Freeze	OFF/ON	
Motion Detection	OFF/ON 4 areas arbitrarily configurable	
Neg. Image	OFF/ON	
Interface	BNC (3G/HD-SDI), 2P connector (Composite video), Power in, Auto iris, mini DIN8P (RC-02, RS-232)	
Power Supply	DC+12V ±10%	
Power Consumption	2.52W (210mA)	
Operating / Storage Temperature	-10 - +50°C / -30 - +70°C	
Operating / Storage Humidity	95%RH or Less (Without condensation)	
Lens Mount	CS mount	
Weight	Approx. 131g	
Accessories	WPDC12-R (DC plug), 2P cable, Hex. wrench, Camera bracket, RC-02 (Remote control)	

*1 Output Format: 60/59.94/30fps *2 Output Format: 50/25/24fps

