

Zoom Camera

# ATC-HZ8240T-LCN



- 1/2.8" SONY Progressive Scan STARVIS CMOS
- 480x AF Zoom(40x optical zoom, 12x digital zoom)
- 1080p 60/50/30/25fps
- Mechanical Day&Night
- True WDR
- 3D DNR, Defog
- UART RS232-TTL(Pelco-D, Pelco C, VISCA, Hitachi)

# ATC-HZ8240T-LCN



· Dimensions

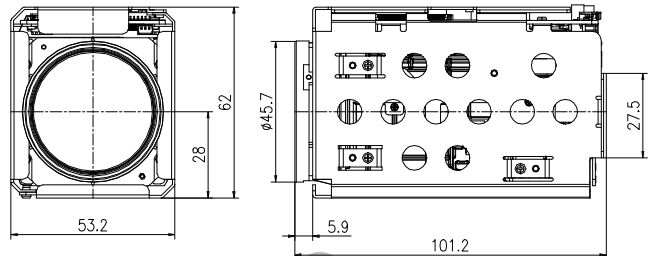

## Specifications

<b>Image Sensor</b>	1/2.8" SONY Progressive Scan STARVIS CMOS
<b>Effective Pixels</b>	2.13MP 1945(H) x 1097(V)
<b>Video Output mode</b>	<b>Common</b> HD-SDI/EX-SDI(V1.0)/EX-SDI(V2.0)/EX-SDI(V3.0)/CVBS <b>AVI/TVI/LVDS</b> TVI/AVI/LVDS
<b>Max. Video Resolution</b>	HD-SDI/LVDS:1080p@60(50fps), <i>9Pin FFC analog cable</i>
<b>Synchronization system</b>	Internal
<b>Min.Illumination</b>	Day mode: 0.1Lux(F1.6) Night mode: 0.07Lux(F1.6/ IR-cut filter on) Sens-Up off, AGC45dB
<b>S/N Rate</b>	More than 52dB(AGC off, Sens-Up off)
<b>Lens</b>	<b>Type</b> AF Optical zoom lens(DC Iris), IR Corrective
	<b>Focal Length</b> f=4.25~170mm
	<b>F-value</b> F1.6(W)~4.95(T)
	<b>Angle of View</b> Horizontal 65.7°(W)~1.9°(T), Vertical 39.4°(W)~1.1°(T)
<b>Zoom ratio</b>	Optical 40x / Digital 12x
<b>Focus Min.Working Distance</b>	0.01m(Wide)/1m(Tele)~∞
<b>Focus Control</b>	Auto/Interval/One Push/Manual/Preset
<b>AE mode</b>	Auto/Shutter Priority/Iris Priority/Manual
<b>Brightness</b>	0~14
<b>Manual Shutter</b>	1/1, 1/2, 1/4(3), 1/8(6), 1/15(12), 1/30(25), 1/60(50)~1/30000
<b>Manual Iris</b>	F1.6~F19, Close
<b>Sense-up</b>	Off~32fields
<b>ETC</b>	Spot AE, Slow AE
<b>D&amp;N Mode</b>	Auto/Day(Color)/Night(BW)/External-H or L
<b>White Balance</b>	AUTO/One Push/Indoor/Outdoor/ATW/Manual
<b>Image Freeze</b>	Off/On
<b>Image Flip</b>	Off/Horizontal/Vertical/H+V(180°Flip)
<b>Privacy Mask Zone</b>	8 Zones/14 mask color selectable
<b>Digital Image Stabilization</b>	Yes
<b>Motion Detection</b>	4 Zones

<b>D-WDR</b>	Off/Low/Middle/High
<b>WDR</b>	Off/On, Adjustable(Level:0~29, Contrast:0~5, Bright:0~19)
<b>BLC</b>	Off/On, Area selectable
<b>HLC</b>	Off/On, Area selectable
<b>AGC</b>	Max.58dB
<b>Sharpness</b>	Adjustable(0~15)
<b>3D-DNR</b>	On/Off(1~5)
<b>2D-DNR</b>	Auto/Manual
<b>Defog</b>	Off/Low/Middle/High
<b>Preset Position</b>	256 position Presets(Zoom,Focus), 16Memory Presets, Custom Preset
<b>Language</b>	English,Japanese,Russian,Spanish,German, France,Portuguese
<b>UART</b>	<b>Remote</b> RS232 TTL + 5.0V(+3.3V compatible)
	<b>Protocol</b> VISCA/Pelco-D/Pelco-P/Hitachi: Automatic detection
	<b>Baud rate</b> 2400/4800/9600/19200/38400/57600/115200bps
<b>UTC</b>	-
<b>Supply Voltage</b>	12VDC(9V to 15VDC)
<b>Power Consumption</b>	Max.5.5W / Non-working zoom&focus 3.3W
<b>Dimension(mm)</b>	53.2x62x101.2mm
<b>Weight</b>	Approx.315g
<b>Operating Temperature</b>	-10°C~+50°C, Humidity(20~80%)
<b>Storage Temperature</b>	-20°C~+60°C, Humidity(20~95%)