

This information is brought to you by:



Zoom Camera

ATC-HZ5512W-LP

- 1/1.8" Progressive Scan Global Shutter CMOS
- 144x AF Zoom(12x optical zoom, 12x digital zoom)
- 1080p 60/50/30/25fps
- Mechanical Day&Night
- True WDR
- 3D DNR, Defog
- UART RS232-TTL(Pleco-D, Pelco C, VISCA, Hitachi)

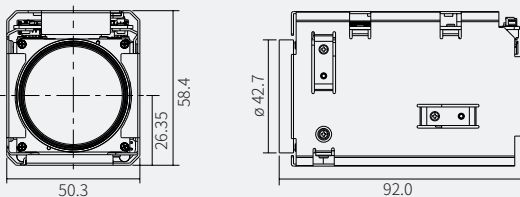

Zoom Camera

ATC-HZ5512W-LP

Dimensions

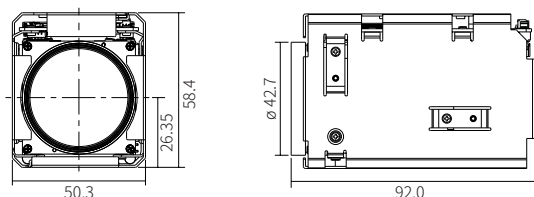

Specifications

| | | |
|------------------------------------|---|--|
| Image Sensor | 1/1.8" Progressive Scan Global Shutter CMOS | |
| Effective Pixels | 3.19MP 2064(H) x 1544(V) | |
| Video Output mode | LVDS / Parallel / CVBS | |
| Max. Video Resolution | LVDS / Parallel : 1080p@60(50fps) | |
| Synchronization system | Internal / External Option | |
| Min.Illumination | Day mode: 0.1(Lux(F1.5)) Night mode: 0.05Lux(F1.5/ IR-cut filter on) DSS OFF, AGC45dB | |
| S/N Rate | More than 55dB(AGC off, DSS off) | |
| Lens | Type | AF Optical zoom lens(DC Iris), IR Corrective |
| | Focal Length | f=7.0mm~84mm |
| | F-value | F1.5(W)~1.9(T) |
| | Angle of View | Horizontal 51.1°(W)~5.0°(T), Vertical 30.0°(W)~3.2°(T) |
| Zoom ratio | Optical 12x / Digital 12x | |
| Focus Min.Working Distance | 0.1m(Wide)/0.5m(Tele)~∞ | |
| Focus Control | Auto/Interval/One Push/Manual/Preset | |
| AE mode | Auto/Shutter Priority/Iris Priority/Manual | |
| Brightness | 0~14 | |
| Manual Shutter | 1/1, 1/2, 1/4(3), 1/8(6), 1/15(12), 1/30(25), 1/60(50)~1/10000 | |
| Manual Iris | F1.6~F32, Close | |
| Sense-up | Off~32fields | |
| ETC | Spot AE, Slow AE | |
| D&N Mode | Auto/Day(Color)/Night(BW)/External-H or L | |
| White Balance | AUTO/One Push/Indoor/Outdoor/ATW/Manual | |
| Image Freeze | Off/On | |
| Image Flip | Off/Horizontal/Vertical/H+V(180° Flip) | |
| Privacy Mask Zone | 8 Zones/14 mask color selectable | |
| Digital Image Stabilization | Yes | |
| Motion Detection | 4 Zones | |

| | | |
|------------------------------|---|--|
| D-WDR | Off/Low/Middle/High | |
| WDR | Off/On, Adjustable(Level:0~29, Contrast:0~5, Bright:0~19) | |
| BLC | Off/On, Area selectable | |
| HLC | Off/On, Area selectable | |
| AGC | Max.48dB | |
| Sharpness | Adjustable(0~15) | |
| 3D-DNR | Off/Auto/Low/Middle/High | |
| 2D-DNR | Off/Auto/Low/Middle/High | |
| Defog | Off/On/Auto | |
| Preset Position | 256 position Presets(Zoom,Focus), 16Memory Presets, Custom Preset | |
| Language | English | |
| UART | Remote | RS232 TTL +5.0V(+3.3V compatible) |
| | Protocol | VISCA/Pelco-D/Pelco-P/Hitachi: Automatic detection |
| | Baud rate | 2400/4800/9600/19200/38400/57600/115200bps |
| UTC | - | |
| Supply Voltage | 12VDC(7V to 15VDC) | |
| Power Consumption | Max.5.3W / Non-working zoom&focus 3.8W | |
| Dimension(mm) | 50.3X58.4X92.0mm | |
| Weight | Approx.253g | |
| Operating Temperature | -10°C~+50°C, Humidity(20~80%) | |
| Storage Temperature | -20°C~+60°C, Humidity(20~95%) | |