

This information is brought to you by:



ELECTRONIC GROUP, INC
 480-635-8400 p * aegis-g2@aegiselect.com
 http://www.aegis-elec.com

VZ-56SM

ANALOG LED TEST MONITOR

VZ-56SM ADVANTAGES

- Large and Easy to View 5.6" LED Display
- Analog and Digital Inputs (Composite-BNC, TVI, AHD, HDMI, VGA)
- DV 12V Camera Power Out
- Audio Support
- Viewable while inside Protective Case
- Ni-Mh Rechargeable Batteries
- Test Pattern Generator
- 2 Year Warranty



MODEL #	VZ-56SM
DISPLAY	
Screen Size	5.6"
Max. Resolution	640 x 480 pixel
Pixel Pitch	0.0588 mm x 0.176 mm
Brightness	200cd/m²(Typical)
Contrast Ratio	500:1
Aspect Ratio	4 : 3
Viewing Angle (H/V)	140° / 120°
Display Color	16.7 Million
Response Time	< 10 ms
Video System	NTSC / PAL
INTERFACE	
Composite In	1
VGA In	1
HDMI In	1
AHD In	1
TVI In	1
Audio (BNC) In	1
AUDIO	
Built in speaker	1W x 1
SPECIAL FEATURES	
Power Saving	Low Power Consumption
	NI-MH Battery
Knob control	YES
Camera Power Out	12V DC / 1500mA
DIMENSIONS	
Outline Dimension (W x H x D) (inch)	6.61 x 4.96 x 3.19
(W x H x D) (mm)	168 x 126 x 81.2
Net Weight	2.2 lbs / 1 kg
GENERAL	
Power - Electrical Ratings	DC 12V (AC100 ~ 240V[50/60Hz])
- Max Consumption	6 W (SDI function enabled, no speaker output)
Warranty - Parts / Labor	2 Year / 2 Year
Operating Temperature	32 - 104°F / 0 - 40°C
Operating Humidity	5 ~ 80% RH
Working voltage of battery	DC 3.7V ~ 4.2V
Regulation	CE
Package Include	5.6" Test Monitor, User Manual Sun Visor, Power Adapter , Ni-MH Battery 12V Power Outlet Cable Protective Case w/ Strap

INTERFACE

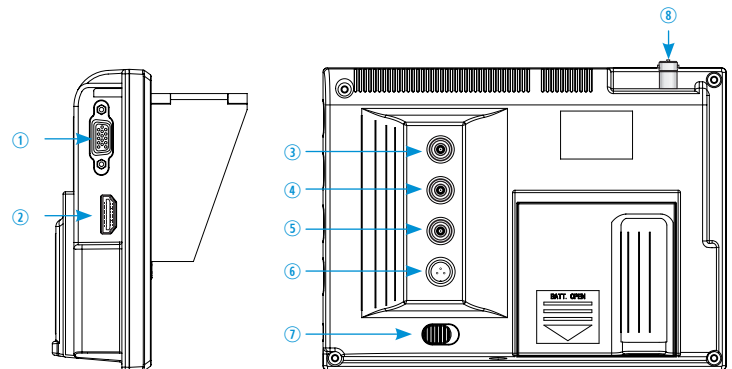

1. VGA Input
2. HDMI Input
3. AHD Input
4. TVI Input
5. Audio Input
6. DC 12V / 1 A Output
7. Power Switch
8. Composite (BNC) 1 Input

VZ-56SM

ANALOG LED TEST MONITOR

DIMENSION

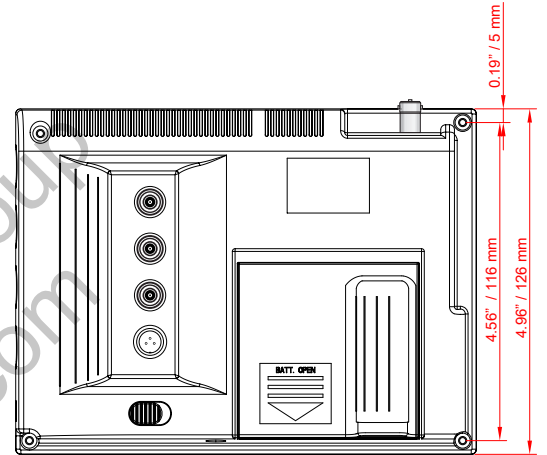
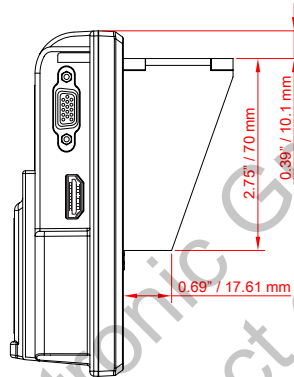
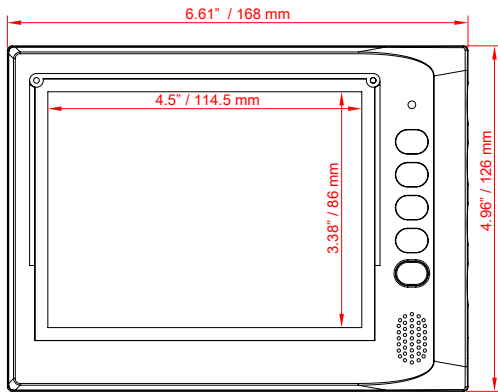
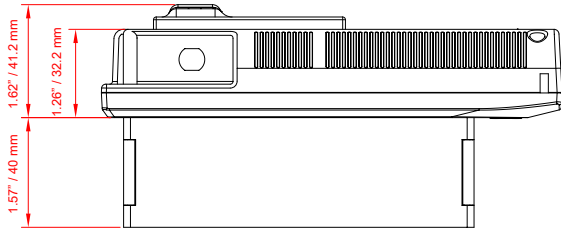

KEY DESCRIPTION

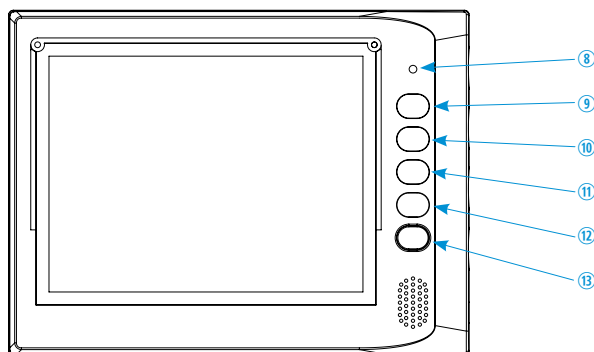
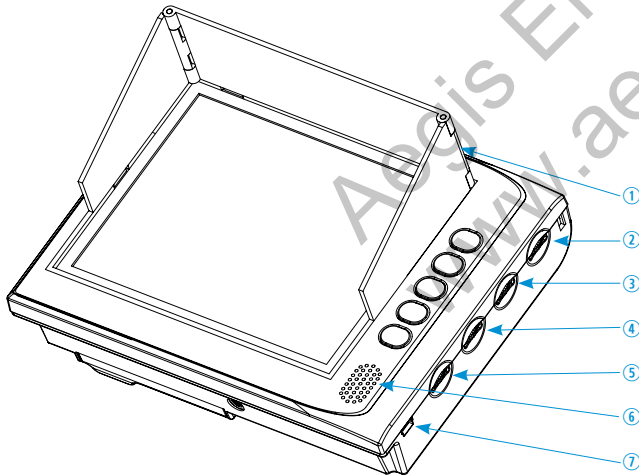

1. Sun Visor
2. Picture brightness adjusting knob
3. Picture contrast adjusting knob
4. Picture saturation adjusting knob
5. Volume adjusting knob
6. Speaker
7. DC12V-1500MA power input
8. LED Indicator
9. MEMU Key
10. Source Key
11. P/G Key
12. VSM Key
13. ESC Key